

+6838550

+27515150

6838550

+27515300

491-404-3-4

## TONTTIEN MUODOSTUMINEN

TONTIT P-ALA (m2) OSAP-ALA (m2) KIINTEISTÖ

TONTIT	P-ALA (m2)	OSAP-ALA (m2)	KIINTEISTÖ
491-29-22-1	1210	1210	491-404-3-33
491-29-22-2	1267	1267	491-404-3-33
491-29-22-3	1257	1257	491-404-3-33
491-29-22-4	1195	1195	491-404-3-33
491-29-22-5	1200	1200	491-404-3-33
491-29-22-6	1200	1200	491-404-3-33
491-29-22-7	1200	1200	491-404-3-33
491-29-22-8	1196	1196	491-404-3-33

## KOORDINAATTILUETTELO

N:o	P	I
1	6838517.528	27515296.365
2	6838494.711	27515289.095
3	6838466.127	27515279.987
4	6838437.542	27515270.880
5	6838408.958	27515261.772
6	6838403.192	27515259.935
7	6838392.448	27515250.602
8	6838381.387	27515246.237
9	6838353.477	27515235.222
10	6838333.455	27515227.321
11	6838325.913	27515223.376
12	6838299.228	27515209.409
13	6838314.152	27515173.429
14	6838341.886	27515184.867
15	6838369.620	27515196.305
16	6838397.354	27515207.742
17	6838421.101	27515223.660
18	6838449.686	27515232.768
19	6838478.270	27515241.875
20	6838506.854	27515250.982
21	6838535.438	27515260.090
22	6838523.699	27515296.934

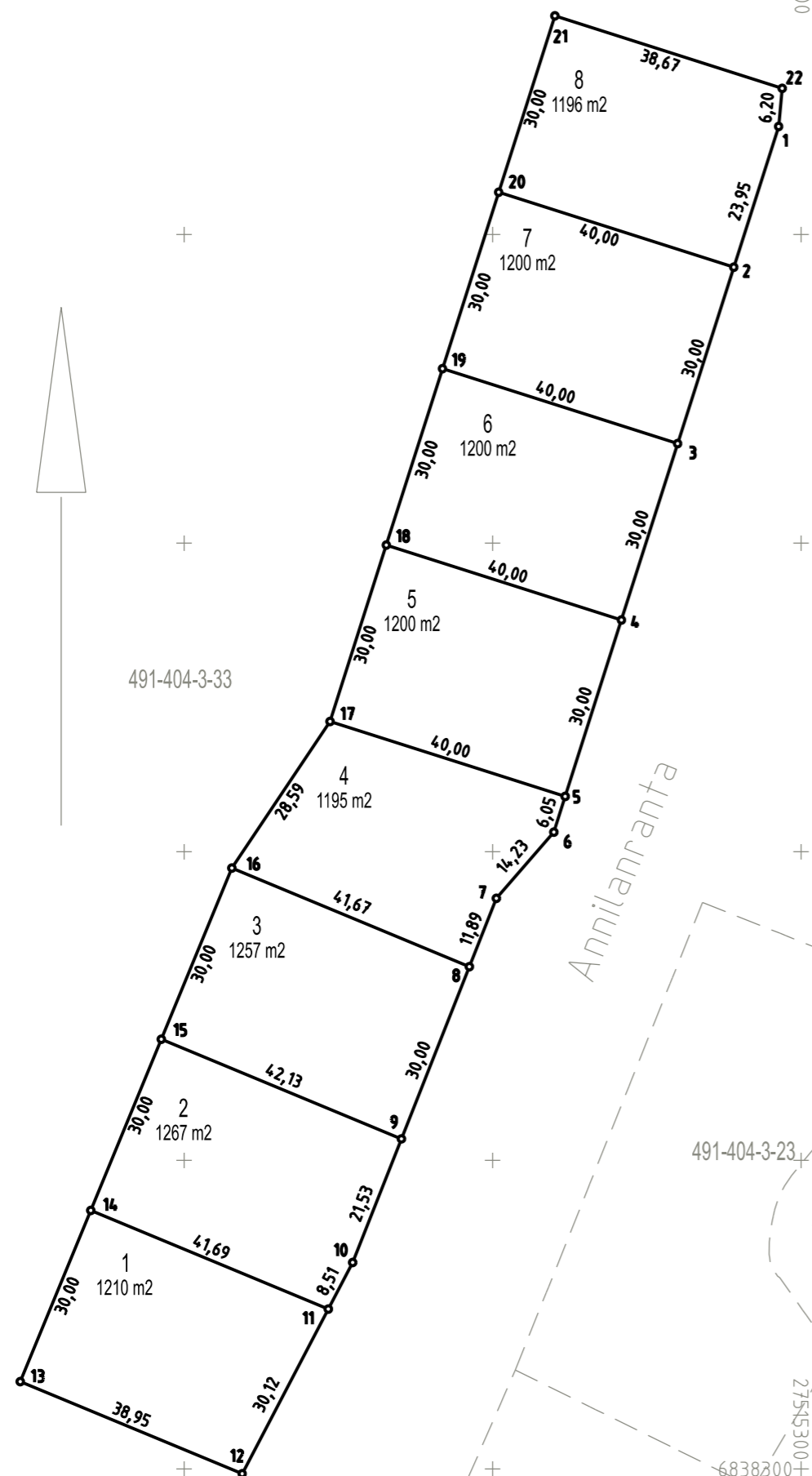

+6838300

+27515150

6838300

+27515300

491-404-3-22

TONTTIJAKO: 29-22/1		1:1000		MIKKELI	
Kaupunginosa:	29 ANNILA	Kortteli:	22	Tontit:	1-8
Asemakaava:	973 / 12.6.2023				
Laskenut:	RL				
Piirtänyt:	IS				
Päätös:					